

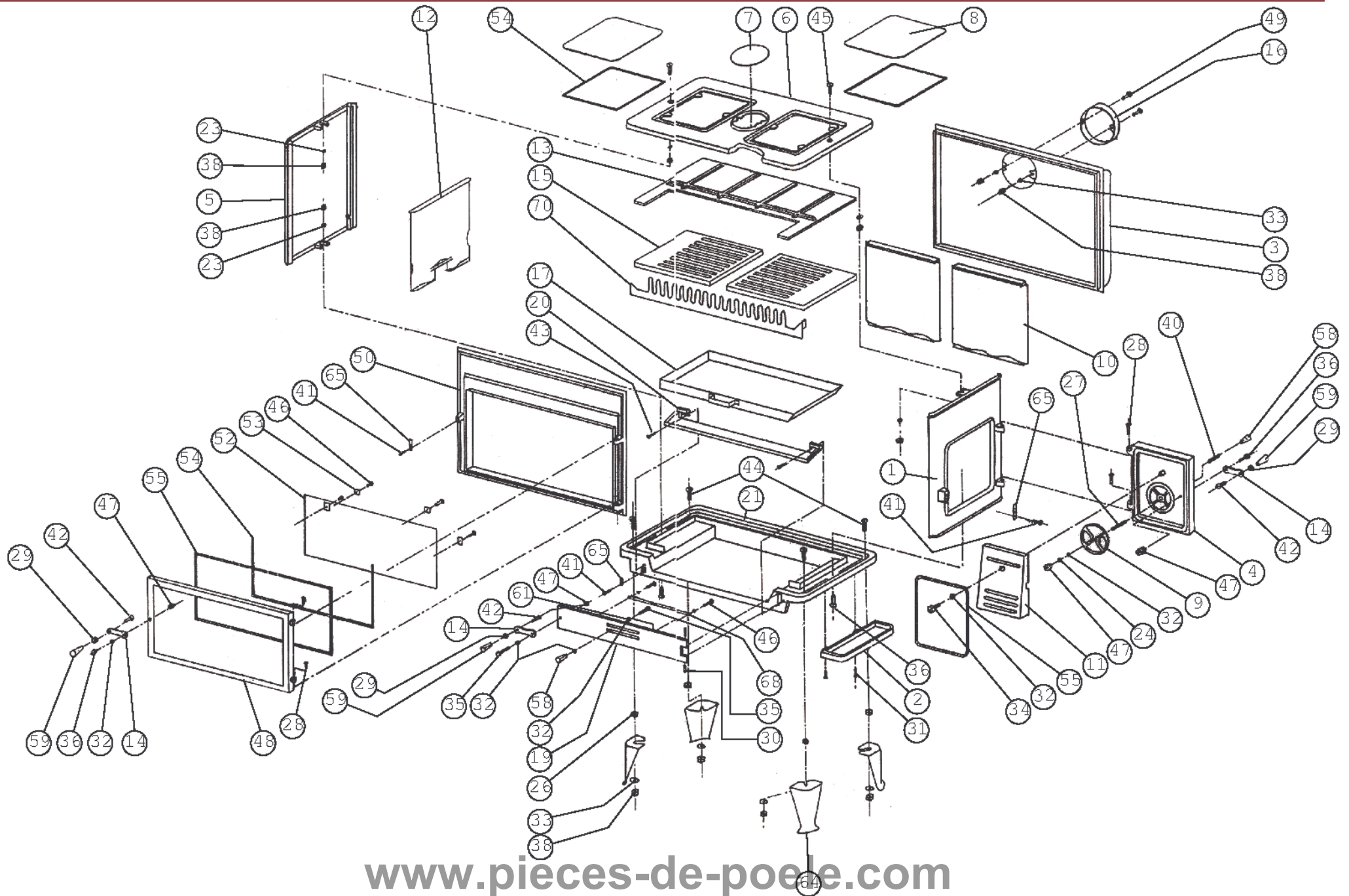

09.90303.000

14/10/08

310GX



N° schema	Intitulé	Référence
1	15231 PORTE LATERALE ASSEMBLÉ	70.15734.020
2	302A BAVETTE 300-2	70.05612.020
7	307 COUVERCLE SANS FIGURES 300-7	70.15321.020
8	307B COUVERCLE CARREE 300-7B	70.15327.020
9	310 volet 37956.0	70.37956.020
10	312 PLAQUE LATERALE INTERIEURE 300-12	70.08316.000
11	313 PORTE INTERIEURE 300-13	70.08204.000
12	314 PLAQUE ARRIERE INTERIEURE 300-14	70.08317.000
13	315G/01 PLAQUE SUPERIEURE INTERIEURE VITRE 300-15G	70.76128.000
14	316 TIGE 300-16	70.63201.020
15	335GX/01 GRILLE R300GX	70.56228.000
17	ASL.310GX BAC A CENDRES 310GX	70.05206.000
48	15447.0 PORTE FACADE ASSEMBLÉ	70.15447.020
52	26029.0 VITRE CERAMIQUE 310GX	70.26029.000
58	BOUTON REGLETTE D'AIR KNP181	70.33026.000
59	bouton KNP.443A	70.33029.000
64	52202.0 PIED 310G	70.52202.020
65	SLP2 PLAQUETTE FERMETURE	70.64013.000
70	77007.0 GARDE-BUCHES 310G	70.77007.020