

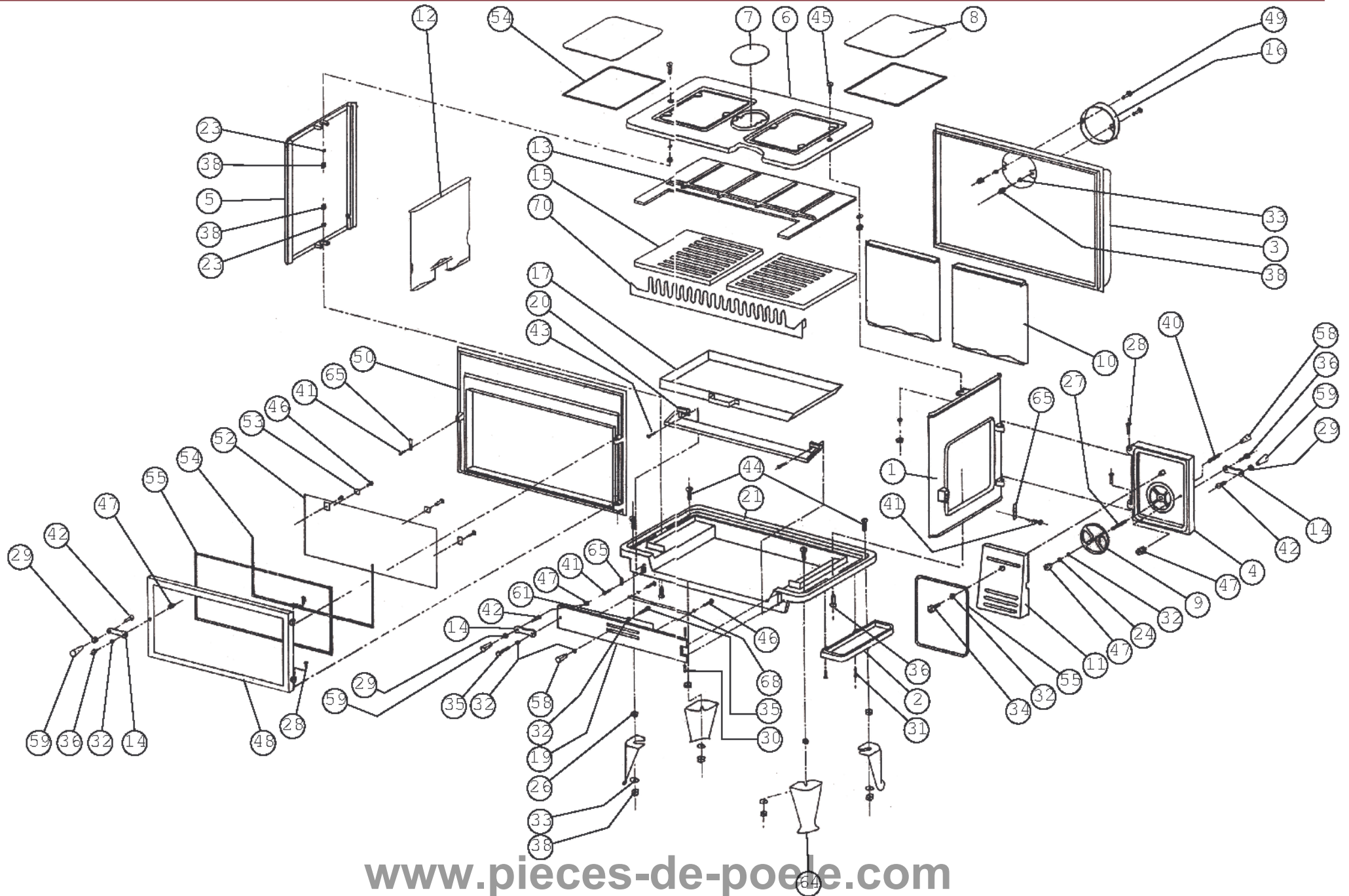

09.90303.000

14/10/08

310GX



N° schema	Intitulé	Référence
1	15231 PORTE LATERALE ASSEMBLÉ	70.15734.020
2	302A BAVETTE 300-2	70.05612.020
7	307 COUVERCLE SANS FIGURES 300-7	70.15321.020
8	307B COUVERCLE CARREE 300-7B	70.15327.020
9	310 volet 37956.0	70.37956.020
10	312 PLAQUE LATERALE INTERIEURE 300-12	70.08316.000
11	313 PORTE INTERIEURE 300-13	70.08204.000
12	314 PLAQUE ARRIERE INTERIEURE 300-14	70.08317.000
13	315G/01 PLAQUE SUPERIEURE INTERIEURE VITRE 300-15G	70.76128.000
14	316 TIGE 300-16	70.63201.020
15	335GX/01 GRILLE R300GX	70.56228.000
17	ASL.310GX BAC A CENDRES 310GX	70.05206.000
27	10 p VIS SANS TETE M6X25	70.17202.000
29	10 p RONDELLE DIN 6798AZ Ø6	70.17601.000
30	10 p SPANSCREW DIN 7343 Ø6X30	70.17806.000
35	10 p BOULON DIN 933 M6x25	70.19306.000
36	10 p BOULON DIN 933 M6x35	70.19308.000
40	10 p GOUJONS M6X30	70.19504.000
41	10 p VIS DIN 963 M6x12	70.19711.000
42	10 p VIS M6X20	70.19714.000
43	10 p VIS DIN 963 M8x12	70.19730.000
44	10 p VIS DIN 963 M8x30	70.19733.000
45	10 p VIS DIN 963 M8x35	70.19734.000
47	10 p M6 ECROU CLEVELOCK	70.20001.000
48	15447.0 PORTE FACADE ASSEMBLÉ	70.15447.020
52	26029.0 VITRE CERAMIQUE 310GX	70.26029.000
58	BOUTON REGLETTE D'AIR KNP181	70.33026.000
59	bouton KNP.443A	70.33029.000
64	52202.0 PIED 310G	70.52202.020
65	SLP2 PLAQUETTE FERMETURE	70.64013.000
70	77007.0 GARDE-BUCHES 310G	70.77007.020